

Novi Cobblestone Installation

Tools and Supplies

1. Nails or Screws
2. Hammer, Screwdriver or Screw gun with the appropriate tip for the screws being used.
3. Snips or Saw for cutting siding
4. Drill
5. Tape Measure
6. Level
7. Color complimenting caulk
8. Aluminum or Flashing
9. Utility Knife

Directions:

CAUTION: REMEMBER THAT POLYMER UNDERGOES EXPANSION / CONTRACTION DUE TO VARIATIONS IN TEMPERATURE. THE FOLLOWING INSTRUCTIONS WILL ALLOW FOR THE EXPANSION / CONTRACTION OF THE MATERIAL. Always begin the installation from left to right and make sure that a wall is completed before beginning a new one. Always begin at the lowest part of the structure.

General Information

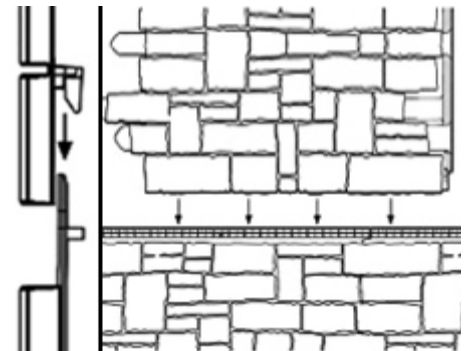
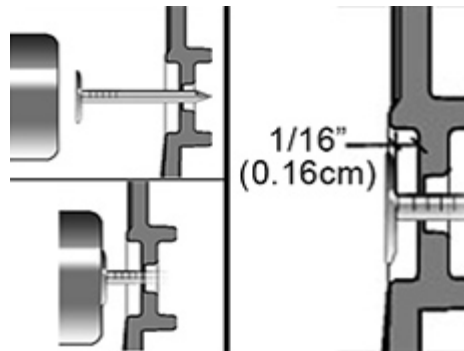
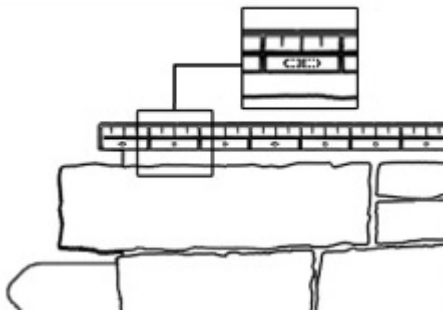

1. Always hammer in the installation holes. These holes include a polymer film, which permits for precise centering of nail allowing the expansion and contraction of the material. Each complete panel must be nailed by 5 nails at maximal intervals of 16"(40,64cm) or less. If synthetic stone walls are installed on a furring wall, a furring strip is required behind each nail. Always use non corrosive nails or screws that must be able to penetrate a minimum of 1 1/2" (3,18cm) into a solid surface.

2. When installing stone siding, never hammer the nails in completely; leave a gap of 1/16" (0.16cm). The stoppers located around the holes stop the hammer from driving the nails in too far, and provides the required gap.

3. Make sure that all pieces are properly joined together.

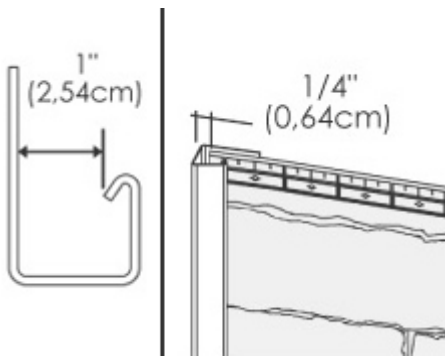

4. When using j-trim, leave a space of 1/4"(0,64cm) between the inside wall of the J-trim and the siding. Use standard 1"(2,54cm) J-trim.

Installation Steps

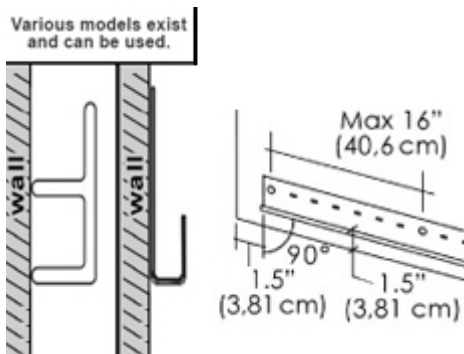

1. Install a starter strip at the lowest point of the wall. Make sure that the horizontal starting line is perfectly level and square with the wall. Leave a 1 1/2" (3,81cm) gap at each extremity of the wall when using decorative corners. If a floor is against the wall then you must leave a gap of 5/8" (1,59cm) between the starter strip and the floor.

Note: Each starter strip is 10' long. To find out how many are needed for your install measure the lineal footage of the base of each wall and divide by 10'.

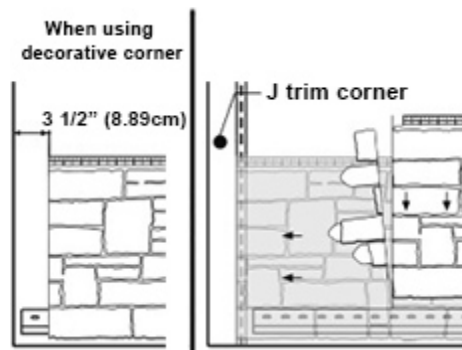

2. When using decorative corners, cut the left side of a panel in a straight line, insert panel into starter strip and nail the panel at 3 1/2"(8,89cm) from the wall edge. When using J-trim corner, cut the left side of a panel in a straight line, insert panel into starter strip and slide it in the J-trim corner. Leave a space of 1/4"(0,64cm) between inside wall of J-trim and the siding. Measure the wall length to determine where to cut your first panel in order to avoid having a very small piece at the right end of the wall. Be sure to align adjacent walls.

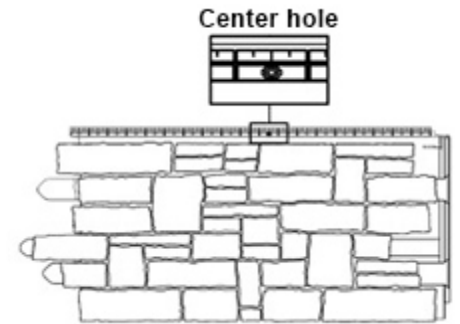

3. On each panel, hammer a nail into the center hole of the panel, this will ensure even movement of synthetic stone walls in both directions during expansion/contraction. Also hammer a nail into the last hole on both ends. If the panel is installed on a furring wall, a furring strip is required behind these holes.- N.B.: If a panel piece does not have the initial center hole in the middle, drill a new center hole of 1/8"(0.32cm) diameter at the same height as the other installation holes. Each full length panel should be secured with a minimum of 5 nails.

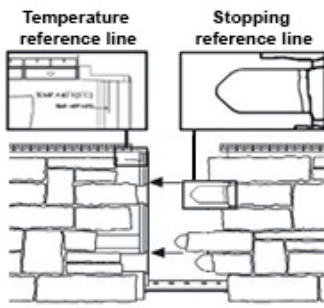

4. Install the following panel by hooking it into the starter strip and sliding over the previous panel. Make sure that the tabs on both sides are locked together and spaced equally. If installed at outdoor temperature over 40°F (5°C), slide panel to the stoppers (located at the rear panel). When resistance is felt, do not force insertion of part. Use the reference line to confirm the position. If installed at outdoor temperature under 40°F (5°C), adjust the panel to the temperature line indicated.

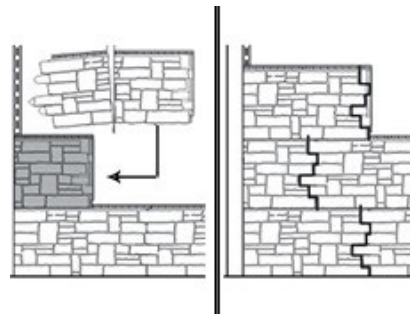

5. Start the second row by cutting the first panel with 16" (40,6cm) increment from the cutting line of the first row. Slide the hooks located at the bottom of the panel into the top of the previously installed row. Proceed with this row and subsequent ones following steps 3 and 4 taking care with each new row to alternate the position of the cut on the panels.

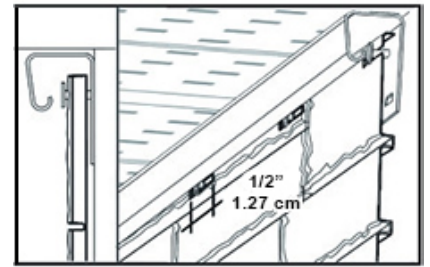

6. While installing stone siding on the last row or places where you may need to attach siding other than in installation holes at a concealed spot on the panel use a knife to create new slots 1/2" (1,27cm); the slot must be wider than the nail but not as wide as the nail head. Although not set in installation holes, this type of cutting will allow the expansion/contraction movement.

Decorative Corner Installation

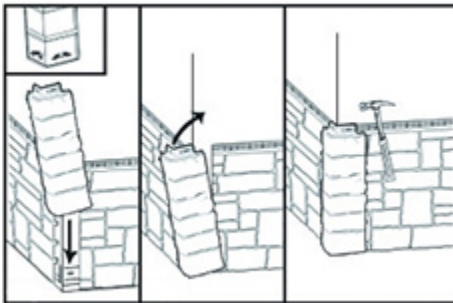

1. Installing stone siding corners can begin once you have completed two adjacent walls. - N.B. For proper installation and optimal corner appearance, make sure that the ends of siding panels finish at 3 1/2" (8,89cm) from the corner of the wall and at an equivalent height.

For the first corner, insert the hooks into the starter strip and be sure to overlap the ends of each row's panels. Fold back the top of the part toward the corner of the wall, then nail through the oblong holes.

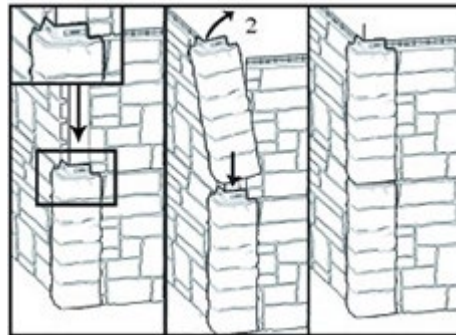

2. For all subsequent corners, insert the hooks into the nailing strip of the previous corner. Fold back the top of the corner toward the wall, then nail through the oblong holes. Repeat this step to the top of the wall.

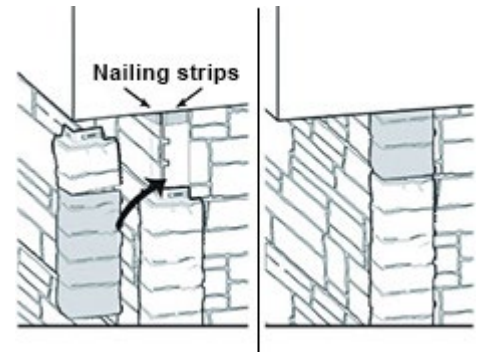

3. For the last corner only, cut excess from part. On each side of the corner, make a hole wider than the shaft of the nail, but smaller than the head. Affix a nailing strip behind these locations to fasten corners firmly. Fold back the top of the corner and nail it down.

If you need to set the siding at an area other than the oblong nail hole or to set accessories on siding, at a concealed spot on the panel create a new slot 1/2" (1,27cm) larger than the nail body but smaller than the nail head to permit expansion/contraction.

* Do not set accessories directly on the siding. The fasteners must be fixed on a solid surface.